



OCEAN FRONT LAND PROPERTY BERABAN BEACH | BALI ISLAND | INDONESIA



© 2018 Photos and Graphics by
Yoshua Daely, Bali Island and
Ulrich H. Kiefer, Europe.
All Rights Reserved.

The *Ocean Front Land Property* is located at the *Beraban Beach*, on the south **Bali Island**. This plot of land is part of a rapid growing island of independent **Southeast Asian Republic of Indonesia**:

- 45 minutes drive from famous sunset destination **Tanah Lot Beach and its Temple** and
- 95 minutes drive from **Ngurah Rai International Airport** of Bali's capital: in SE Asia a leading **tourist destination**: central market **Denpasar** city.
- This land property is **free from government regulation** related to **green zone** area.
- Beraban Beach is *aside* to **Pasut Beach** and **Antap Beach**.

Yoshua Daely **Bali – Indonesia**
Profile: [about.me / yoshua](https://about.me/yoshua)
Email: [yoshua.daely @ gmail.com](mailto:yoshua.daely@gmail.com)
Mobile / WA: +62(0) 811 387 205

Partner-DE: **Ulrich H. Kiefer | Central-EU**
Web-Links: [about.me / ulrichkiefer](https://about.me/ulrichkiefer)
Reply to: cvide.com/kiefer/?page_id=1928
Fon/AM\Fax: +49(0) 7808/51 74 – 847 | - 687



OCEAN FRONT LAND PROPERTY BERABAN BEACH | BALI ISLAND | INDONESIA



© 2018 Photos and Graphics by
Yoshua Daely, Bali Island and
Ulrich H. Kiefer, Europe.
All Rights Reserved.



Presenting the west wing of
the unique land property.

Yoshua Daely **Bali – Indonesia**
Profile: [about.me / yoshua](https://about.me/yoshua)
Email: [yoshua.daely @ gmail.com](mailto:yoshua.daely@gmail.com)
Mobile / WA: +62(0) 811 387 205

Partner-DE: **Ulrich H. Kiefer | Central-EU**
Web-Links: [about.me / ulrichkiefer](https://about.me/ulrichkiefer)
Reply to: cvide.com/kiefer/?page_id=1928
Fon/AM\Fax: +49(0) 7808/51 74 – 847 | - 687



OCEAN FRONT LAND PROPERTY BERABAN BEACH | BALI ISLAND | INDONESIA



© 2018 Photos and Graphics by
Yoshua Daely, Bali Island and
Ulrich H. Kiefer, Europe.
All Rights Reserved.



Freehold title or freehold ownership with a total land size of **59.305** square meters: therefore, based on the actual currency rate of the Indonesian Rupiah and the Euro, this is a **special and fair price offer**.

The land price of EUR 245 per m2 include a split - 10 percent - Value Added Tax, the costs for the legal document, the permits arrangements and the public fees, i.e. for the notary and the property agent.

Yoshua Daely **Bali – Indonesia**
Profile: [about.me / yoshua](#)
Email: [yoshua.daely @ gmail.com](mailto:yoshua.daely@gmail.com)
Mobile / WA: +62(0) 811 387 205

Partner-DE: **Ulrich H. Kiefer | Central-EU**
Web-Links: [about.me / ulrichhkiefer](#)
Reply to: cvide.com/kiefer/?page_id=1928
Fon/AM\Fax: +49(0) 7808/51 74 – 847 | - 687



OCEAN FRONT LAND PROPERTY BERABAN BEACH | BALI ISLAND | INDONESIA



© 2018 Photos and Graphics by
Yoshua Daely, Bali Island and
Ulrich H. Kiefer, Europe.
All Rights Reserved.



Presenting the main access road to
the unique land property.

Yoshua Daely **Bali – Indonesia**
Profile: [about.me / yoshua](https://about.me/yoshua)
Email: [yoshua.daely @ gmail.com](mailto:yoshua.daely@gmail.com)
Mobile / WA: +62(0) 811 387 205

Partner-DE: **Ulrich H. Kiefer | Central-EU**
Web-Links: [about.me / ulrichhkiefer](https://about.me/ulrichhkiefer)
Reply to: cvide.com/kiefer/?page_id=1928
Fon/AM\Fax: +49(0) 7808/51 74 – 847 | - 687



OCEAN FRONT LAND PROPERTY BERABAN BEACH | BALI ISLAND | INDONESIA



© 2018 Photos and Graphics by
Yoshua Daely, Bali Island and
Ulrich H. Kiefer, Europe.
All Rights Reserved.



Presenting the east wing access
road (Bimasena Road) to O. F. L. P.

Yoshua Daely **Bali – Indonesia**
Profile: [about.me / yoshua](https://about.me/yoshua)
Email: [yoshua.daely @ gmail.com](mailto:yoshua.daely@gmail.com)
Mobile / WA: +62(0) 811 387 205

Partner-DE: **Ulrich H. Kiefer | Central-EU**
Web-Links: [about.me / ulrichkiefer](https://about.me/ulrichkiefer)
Reply to: cvide.com/kiefer/?page_id=1928
Fon/AM|Fax: +49(0) 7808/51 74 – 847 | - 687



OCEAN FRONT LAND PROPERTY BERABAN BEACH | BALI ISLAND | INDONESIA



© 2018 Photos and Graphics by
Yoshua Daely, Bali Island and
Ulrich H. Kiefer, Europe.
All Rights Reserved.

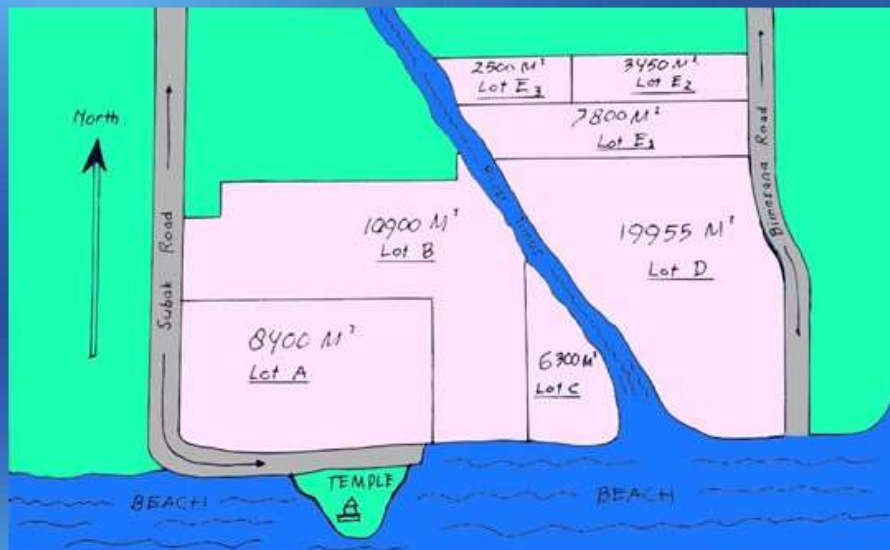

This map shows the shape of the O. F. L. P. with clear borderline:

On the

- West border is *Subak Aseman Road*,
- South border is the *Beraban Beach*,
- East border is *Bimasena Road*,
- North border is a *rice field*.

Yoshua Daely **Bali – Indonesia**
Profile: [about.me / yoshua](https://www.about.me/yoshua)
Email: [yoshua.daely @ gmail.com](mailto:yoshua.daely@gmail.com)
Mobile / WA: +62(0) 811 387 205

Partner-DE: **Ulrich H. Kiefer | Central-EU**
Web-Links: [about.me / ulrichkiefer](https://www.about.me/ulrichkiefer)
Reply to: [cvide.com/kiefer/?page_id=1928](https://www.cvide.com/kiefer/?page_id=1928)
Fon/AM\Fax: +49(0) 7808/51 74 – 847 | - 687

OCEAN FRONT LAND PROPERTY

BERABAN BEACH | BALI ISLAND | INDONESIA

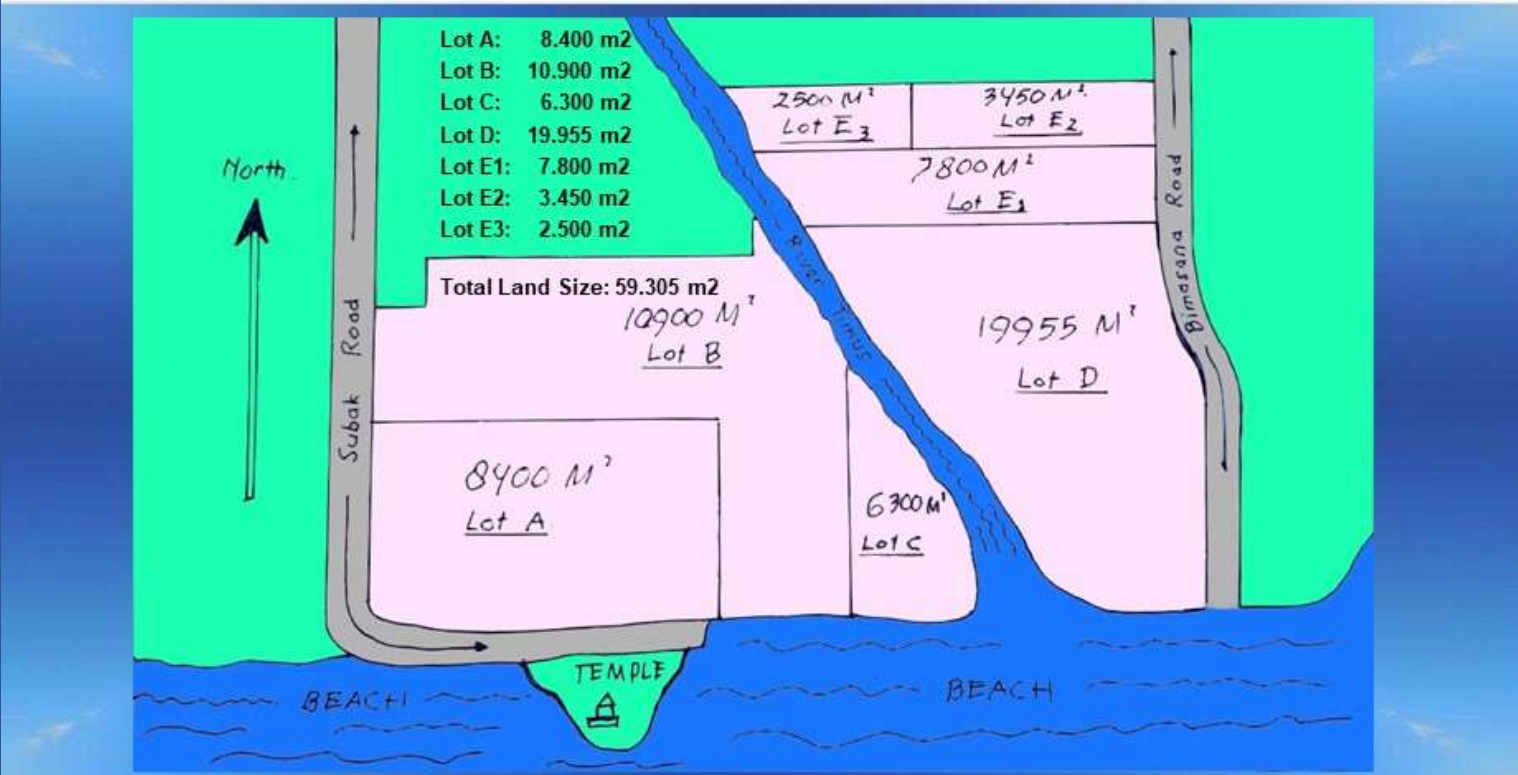

Yoshua Daely **Bali – Indonesia**
Profile: [about.me / yoshua](#)
Email: yoshua.daely@gmail.com
Mobile / WA: +62(0) 811 387 205

Partner-DE: **Ulrich H. Kiefer | Central-EU**
Web-Links: [about.me / ulrichkiefer](#)
Reply to: cvide.com/kiefer/?page_id=1928
Fon/AM|Fax: +49(0) 7808/51 74 – 847 | - 687



OCEAN FRONT LAND PROPERTY BERABAN BEACH | BALI ISLAND | INDONESIA



© 2018 Photos and Graphics by
Yoshua Daely, Bali Island and
Ulrich H. Kiefer, Europe.
All Rights Reserved.



Presenting the *Beraban Beach* with
the fine black sandy environment.

Yoshua Daely **Bali – Indonesia**
Profile: [about.me / yoshua](#)
Email: [yoshua.daely @ gmail.com](mailto:yoshua.daely@gmail.com)
Mobile / WA: +62(0) 811 387 205

Partner-DE: **Ulrich H. Kiefer | Central-EU**
Web-Links: [about.me / ulrichkiefer](#)
Reply to: cvide.com/kiefer/?page_id=1928
Fon/AM\Fax: +49(0) 7808/51 74 – 847 | - 687



OCEAN FRONT LAND PROPERTY BERABAN BEACH | BALI ISLAND | INDONESIA



© 2018 Photos and Graphics by
Yoshua Daely, Bali Island and
Ulrich H. Kiefer, Europe.
All Rights Reserved.



Presenting the views on the
environment close to *Beraban
Beach*, including palm trees.

Thank You for
Your interested feedback.

Yoshua Daely **Bali – Indonesia**
Profile: [about.me / yoshua](https://about.me/yoshua)
Email: [yoshua.daely @ gmail.com](mailto:yoshua.daely@gmail.com)
Mobile / WA: +62(0) 811 387 205

Partner-DE: **Ulrich H. Kiefer | Central-EU**
Web-Links: [about.me / ulrichkiefer](https://about.me/ulrichkiefer)
Reply to: cvide.com/kiefer/?page_id=1928
Fon/AM\Fax: +49(0) 7808/51 74 – 847 | - 687



OCEAN FRONT LAND PROPERTY BERABAN BEACH | BALI ISLAND | INDONESIA



© 2018 Photos and Graphics by
Yoshua Daely, Bali Island and
Ulrich H. Kiefer, Europe.
All Rights Reserved.



Yoshua Daely **Bali – Indonesia**
Profile: [about.me / yoshua](https://about.me/yoshua)
Email: [yoshua.daely @ gmail.com](mailto:yoshua.daely@gmail.com)
Mobile / WA: +62(0) 811 387 205

Partner-DE: **Ulrich H. Kiefer | Central-EU**
Web-Links: [about.me / ulrichkiefer](https://about.me/ulrichkiefer)
Reply to: cvide.com/kiefer/?page_id=1928
Fon/AM\Fax: +49(0) 7808/51 74 – 847 | - 687



© 2018 Photos and Graphics by
Joshua Dasly, Bell Island and
Ulrich H. Kiefer, Europe.
All Rights Reserved.